

SL08



SOUTH LAKELAND DISTRICT COUNCIL
Public Protection Group,
Licensing Team, South Lakeland House, Lowther Street,
Kendal, Cumbria LA9 4UD
Tel: (01539 733333) Fax: (01539) 740300
www.southlakeland.gov.uk e-mail: licensing@southlakeland.gov.uk

Application to vary a premises licence under the Licensing Act 2003

PLEASE READ THE FOLLOWING INSTRUCTIONS FIRST

Before completing this form please read the guidance notes at the end of the form. If you are completing this form by hand please write legibly in block capitals. In all cases ensure that your answers are inside the boxes and written in black ink. Use additional sheets if necessary.

You may wish to keep a copy of the completed form for your records.

I/We ANNETTE LOUISE DUTTON

(Insert name(s) of applicant)

being the premises licence holder, apply to vary a premises licence under section 34 of the Licensing Act 2003 for the premises described in Part 1 below

Premises licence number PL(A)0249

Part 1 – Premises Details

Postal address of premises or, if none, ordnance survey map reference or description The Pig 13 Crescent Road			
Post town	Windermere	Postcode	LA23 1EA

Telephone number at premises (if any)	01539 234010
Non-domestic rateable value of premises	£14,750

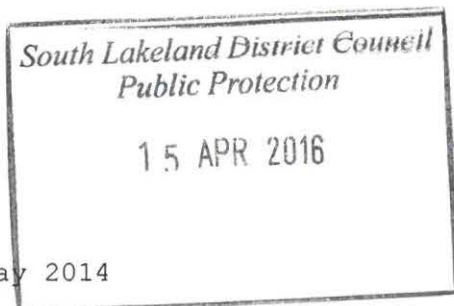

Receipt No 241785
Initials EME
Date 15.04.16

18/04/16 on to proceed DL.

Part 2 – Applicant details

Daytime contact telephone number	01594 47837		
E-mail address (optional)	headoffice@dutton-cuisine.co.uk		
Current postal address if different from premises address			
Post town		Postcode	

Part 3 - Variation

Please tick as appropriate

Do you want the proposed variation to have effect as soon as possible? Yes No

If not, from what date do you want the variation to take effect?

DD	MM	YYYY
<input type="text"/>	<input type="text"/>	<input type="text"/>

Please describe briefly the nature of the proposed variation (Please see guidance note 1)

The Pig is a small café bar in the centre of Windermere and currently has a licence for the sale of alcohol with food, the proposed variation is to remove that condition and allow the sale of alcohol for consumption on or off the premises to enable customers to consume alcohol outside the premises at tables in the designated street café area.

To remove all current restaurant licence conditions and replace with mandatory conditions under Licensing Act 2003.

To increase the licensed area to include pavement café on Crescent Road and to permit the sale of alcohol for consumption both on and off the premises.

To amend the alcohol sales times.

If your proposed variation would mean that 5,000 or more people

are expected to attend the premises at any one time, please state the number expected to attend:

Part 4 Operating Schedule

Please complete those parts of the Operating Schedule below which would be subject to change if this application to vary is successful.

Provision of regulated entertainment

Please tick all that apply

- a) plays (if ticking yes, fill in box A)
- b) films (if ticking yes, fill in box B)
- c) indoor sporting events (if ticking yes, fill in box C)
- d) boxing or wrestling entertainment (if ticking yes, fill in box D)
- e) live music (if ticking yes, fill in box E)
- f) recorded music (if ticking yes, fill in box F)
- g) performances of dance (if ticking yes, fill in box G)
- h) anything of a similar description to that falling within (e), (f) or (g) (if ticking yes, fill in box H)
- i) Provision of late night refreshment (if ticking yes, fill in box I)
- j) Sale by retail of alcohol (if ticking yes, fill in box J)

In all cases complete boxes K, L and M

A

Plays Standard days and timings (please read guidance note 6)			<u>Will the performance of a play take place indoors or outdoors or both – please tick (please read guidance note 2)</u>	Indoors	<input type="checkbox"/>
				Outdoors	<input type="checkbox"/>
				Both	<input type="checkbox"/>
Day	Start	Finish	<u>Please give further details here (please read guidance note 3)</u>		
Mon					
Tue			<u>State any seasonal variations for performing plays (please read guidance note 4)</u>		
Wed					
Thur			<u>Non standard timings. Where you intend to use the premises for the performance of plays at different times to those listed in the column on the left, please list (please read guidance note 5)</u>		
Fri					
Sat					
Sun					

B

Films Standard days and timings (please read guidance note 6)			<u>Will the exhibition of films take place indoors or outdoors or both – please tick (please read guidance note 2)</u>	Indoors	<input type="checkbox"/>
				Outdoors	<input type="checkbox"/>
				Both	<input type="checkbox"/>
Day	Start	Finish	<u>Please give further details here (please read guidance note 3)</u>		
Mon					
			<u>State any seasonal variations for the exhibition of films (please read guidance note 4)</u>		
Tue					
			<u>Non standard timings. Where you intend to use the premises for the exhibition of films at different times to those listed in the column on the left, please list (please read guidance note 5)</u>		
Wed					
Thur					
Fri					
Sat					
Sun					

C

Indoor sporting events Standard days and timings (please read guidance note 6)			<u>Please give further details</u> (please read guidance note 3)
Day	Start	Finish	
Mon			
Tue			<u>State any seasonal variations for indoor sporting events</u> (please read guidance note 4)
Wed			
Thur			<u>Non standard timings. Where you intend to use the premises for indoor sporting events at different times to those listed in the column on the left, please list</u> (please read guidance note 5)
Fri			
Sat			
Sun			

D

Boxing or wrestling entertainments Standard days and timings (please read guidance note 6)			Will the boxing or wrestling entertainment take place indoors or outdoors or both – please tick (please read guidance note 2)	Indoors	<input type="checkbox"/>
				Outdoors	<input type="checkbox"/>
				Both	<input type="checkbox"/>
Day	Start	Finish			
Mon			<u>Please give further details here</u> (please read guidance note 3)		
Tue					
Wed			<u>State any seasonal variations for boxing or wrestling entertainment</u> (please read guidance note 4)		
Thur					
Fri			<u>Non standard timings. Where you intend to use the premises for boxing or wrestling entertainment at different times to those listed in the column on the left, please list</u> (please read guidance note 5)		
Sat					
Sun					

E

Live music Standard days and timings (please read guidance note 6)			Will the performance of live music take place <u>indoors or outdoors or both – please tick</u> (please read guidance note 2)	Indoors	<input type="checkbox"/>
				Outdoors	<input type="checkbox"/>
				Both	<input type="checkbox"/>
Day	Start	Finish	Please give further details here (please read guidance note 3)		
Mon					
Tue			State any seasonal variations for the performance of live music (please read guidance note 4)		
Wed					
Thur			Non standard timings. Where you intend to use the premises for the <u>performance of live music at different times to those listed in the column on the left, please list</u> (please read guidance note 5)		
Fri					
Sat					
Sun					

F

Recorded music Standard days and timings (please read guidance note 6)			<u>Will the playing of recorded music take place indoors or outdoors or both – please tick (please read guidance note 2)</u>	Indoors	<input type="checkbox"/>
				Outdoors	<input type="checkbox"/>
				Both	<input type="checkbox"/>
Day	Start	Finish	<u>Please give further details here (please read guidance note 3)</u>		
Mon					
Tue			<u>State any seasonal variations for the playing of recorded music (please read guidance note 4)</u>		
Wed					
Thur			<u>Non standard timings. Where you intend to use the premises for the playing of recorded music at different times to those listed in the column on the left, please list (please read guidance note 5)</u>		
Fri					
Sat					
Sun					

G

Performances of dance Standard days and timings (please read guidance note 6)			Will the performance of dance take place indoors or outdoors or both – please tick (please read guidance note 2)	Indoors	<input type="checkbox"/>
Day	Start	Finish		Outdoors	<input type="checkbox"/>
Mon			Please give further details here (please read guidance note 3)	Both	<input type="checkbox"/>
Tue					
Wed			State any seasonal variations for the performance of dance (please read guidance note 4)		
Thur					
Fri			Non standard timings. Where you intend to use the premises for the performance of dance at different times to those listed in the column on the left, please list (please read guidance note 5)		
Sat					
Sun					

H

Anything of a similar description to that falling within (e), (f) or (g) Standard days and timings (please read guidance note 6)			Please give a description of the type of entertainment you will be providing		
Day	Start	Finish	<u>Will this entertainment take place indoors or outdoors or both – please tick</u> (please read guidance note 2)	Indoors	<input type="checkbox"/>
Mon				Outdoors	<input type="checkbox"/>
				Both	<input type="checkbox"/>
Tue			<u>Please give further details here</u> (please read guidance note 3)		
Wed					
Thur			<u>State any seasonal variations for entertainment of a similar description to that falling within (e), (f) or (g)</u> (please read guidance note 4)		
Fri					
Sat			<u>Non standard timings. Where you intend to use the premises for the entertainment of a similar description to that falling within (e), (f) or (g) at different times to those listed in the column on the left, please list</u> (please read guidance note 5)		
Sun					

1

Late night refreshment Standard days and timings (please read guidance note 6)			Will the provision of late night refreshment <u>take place indoors or outdoors or both –</u> <u>please tick</u> (please read guidance note 2)	Indoors	<input checked="" type="checkbox"/>
Day	Start	Finish		Outdoors	<input type="checkbox"/>
Mon	23:00	00:00	Please give further details here (please read guidance note 3) No late night refreshments to be consumed outside after 23:00	Both	<input type="checkbox"/>
Tue	23:00	00:00			
Wed	23:00	00:00	State any seasonal variations for the provision of late night refreshment (please read guidance note 4)		
Thur	23:00	00:00			
Fri	23:00	00:00	Non standard timings. Where you intend to use the premises for the provision of late night refreshment at different times, to those listed in the column on the left, please list (please read guidance note 5)		
Sat	23:00	00:00			
Sun	23:00	23:30			

J

Supply of alcohol Standard days and timings (please read guidance note 6)			Will the supply of alcohol be for consumption – please tick (please read guidance note 7)	On the premises	<input type="checkbox"/>
Day	Start	Finish		Off the premises	<input type="checkbox"/>
Mon	10:00	00:00	State any seasonal variations for the supply of alcohol! (please read guidance note 4)	Both	<input checked="" type="checkbox"/>
Tue	10:00	00:00			
Wed	10:00	00:00			
Thur	10:00	00:00		Non-standard timings. Where you intend to use the premises for the supply of alcohol at different times to those listed in the column on the left, please list (please read guidance note 5)	
Fri	10:00	00:00			Christmas Eve – from 10:00 until 01:00
Sat	10:00	00:00			New Years Eve – from 10:00 until 01:00
Sun	10:00	23:30			

K

Please highlight any adult entertainment or services, activities, other entertainment or matters ancillary to the use of the premises that may give rise to concern in respect of children (please read guidance note 8).

None

L

Hours premises are open to the public Standard days and timings (please read guidance note 6)			State any seasonal variations (please read guidance note 4) Christmas Eve – from 10:00 until 01:30 New Years Eve – from 10:00 until 01:30
Day	Start	Finish	Non standard timings. Where you intend the premises to be open to the public at different times from those listed in the column on the left, please list (please read guidance note 5)
Mon	10:00	00:30	
Tue	10:00	00:30	
Wed	10:00	00:30	
Thur	10:00	00:30	
Fri	10:00	00:30	
Sat	10:00	00:30	
Sun	10:00	00:30	

Please identify those conditions currently imposed on the licence which you believe could be removed as a consequence of the proposed variation you are seeking.

Remove all existing restaurant licence conditions and replace with Mandatory Conditions

Please tick as appropriate

- I have enclosed the premises licence
- I have enclosed the relevant part of the premises licence

If you have not ticked one of these boxes, please fill in reasons for not including the licence or part of it below

Reasons why I have not enclosed the premises licence or relevant part of premises licence.

M

Describe any additional steps you intend to take to promote the four licensing objectives as a result of the proposed variation:

a) General – all four licensing objectives (b, c, d and e) (please read guidance note 9)

- All staff shall be trained to comply with the requirements of the Licensing Act 2003
- Installation of remotely monitored CCTV system both inside and out

b) The prevention of crime and disorder

- Actively participate in the Windermere & Bowness Bar Watch scheme.

c) Public safety

- CCTV inside and outside the premises.
- Barrier around outside seating area;
- Outside seating and barrier shall be removed at 23:00.

d) The prevention of public nuisance

- CCTV
- All seating outside removed at 23:00 and no drinking allowed outside after 23:00
- Background music shall not be played outside
- Background music played inside shall be reduced in volume half an hour before closing

e) The protection of children from harm

- Children under the age of 16 are not allowed in the premises after 21:00

Checklist:

Please tick to indicate agreement

- I have made or enclosed payment of the fee.
- I have sent copies of this application and the plan to responsible authorities and others where applicable.
- I understand that I must now advertise my application.
- I have enclosed the premises licence or relevant part of it or explanation.
- I understand that if I do not comply with the above requirements my application will be rejected.

IT IS AN OFFENCE, LIABLE ON SUMMARY CONVICTION TO A FINE NOT EXCEEDING LEVEL 5 ON THE STANDARD SCALE, UNDER SECTION 158 OF THE LICENSING ACT 2003, TO MAKE A FALSE STATEMENT IN OR IN CONNECTION WITH THIS APPLICATION.

Part 5 – Signatures (please read guidance note 10)

Signature of applicant (the current premises licence holder) or applicant’s solicitor or other duly authorised agent (please read guidance note 11). **If signing on behalf of the applicant, please state in what capacity.**

Signature	A L Dutton
Date	14/4/2016.
Capacity	Director

Where the premises licence is jointly held, signature of 2nd applicant (the current premises licence holder) or 2nd applicant’s solicitor or other authorised agent (please read guidance note 12). **If signing on behalf of the applicant, please state in what capacity.**

Signature	
Date	
Capacity	

Contact name (where not previously given) and address for correspondence associated with this application (please read guidance note 13)

Mr Ian Dutton
The Pig
13 Crescent Road

Post town	Windermere	Post code	LA23 1EA
Telephone number (if any)	015394 47837		
If you would prefer us to correspond with you by e-mail, your e-mail address (optional)			
headoffice@dutton-cuisine.co.uk			

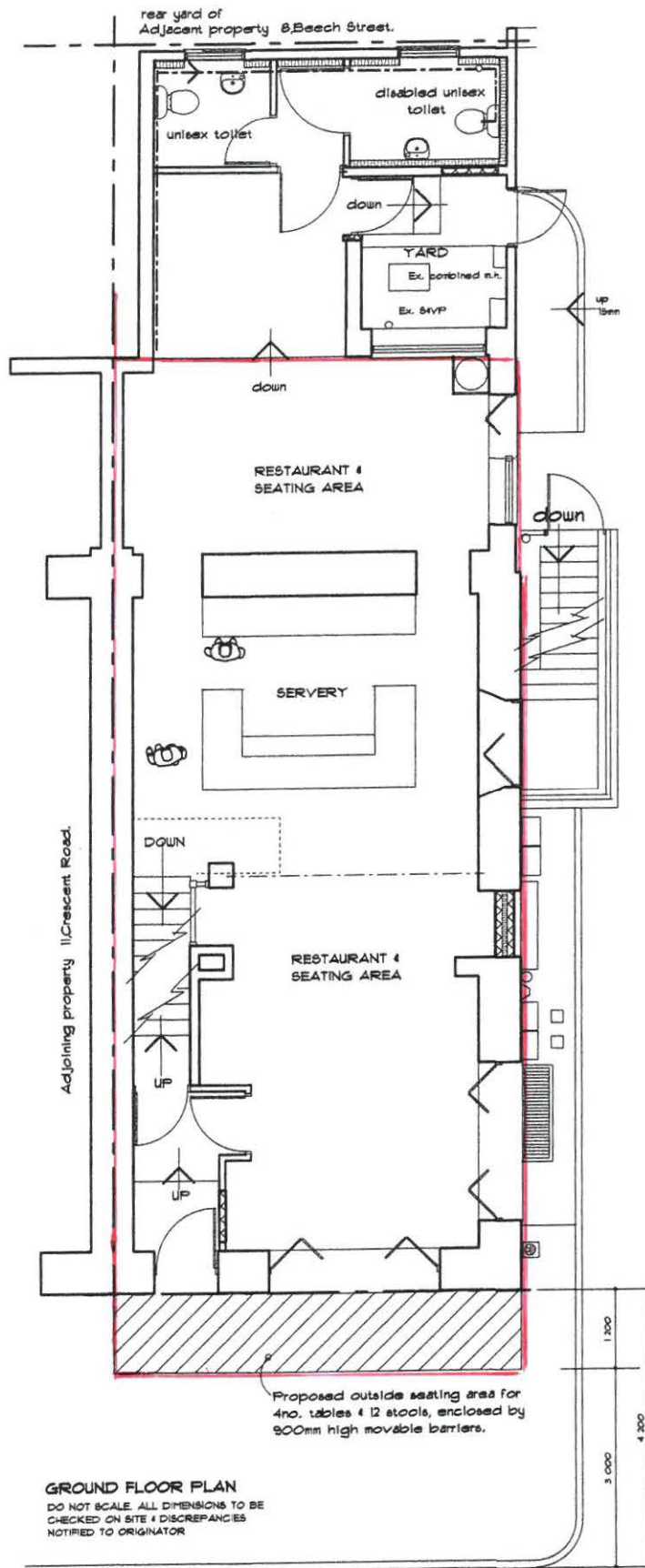

AREA WITHIN
 RED LINE IS
 THE AREA OF
 THE PREMISES
 FOR SALE AND
 CONSUMPTION OF
 ALCOHOL.

GROUND FLOOR PLAN
 DO NOT SCALE. ALL DIMENSIONS TO BE
 CHECKED ON SITE & DISCREPANCIES
 NOTIFIED TO ORIGINATOR